

# IMPLANON® (etonogestrel implant)

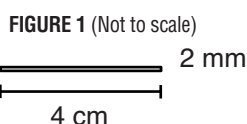
68 mg

For Subdermal Use Only

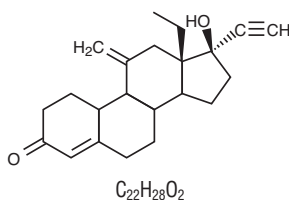
Women should be informed that this product does not protect against infection from HIV (the virus that causes AIDS) or other sexually transmitted diseases.

## DESCRIPTION

IMPLANON® (etonogestrel implant) is an off-white, nonbiodegradable, etonogestrel-containing single sterile rod implant for subdermal use. The implant is 4 cm in length with a diameter of 2 mm (see **Figure 1**). Each IMPLANON rod consists of an ethylene vinylacetate (EVA) copolymer core, containing 68 mg of the synthetic progestin etonogestrel (ENG), surrounded by an EVA copolymer skin. The release rate is 60 to 70 mcg/day in Week 5 to 6 and decreases to approximately 35 to 45 mcg/day at the end of the first year, to approximately 30 to 40 mcg/day at the end of the second year, and then to approximately 25 to 30 mcg/day at the end of the third year. IMPLANON is a progestin-only contraceptive and does not contain estrogen. IMPLANON does not contain latex and is not radio-opaque.



ENG [13-Ethyl-17-hydroxy-11-methylene-18,19-dinor-17 $\alpha$ -pregn-4-en-20-yn-3-one], structurally derived from 19-nortestosterone, is the synthetic biologically active metabolite of the synthetic progestin desogestrel. It has a molecular weight of 324.46 and the following structural formula:



## CLINICAL PHARMACOLOGY

### Pharmacodynamics

The contraceptive effect of IMPLANON® (etonogestrel implant) is achieved by several mechanisms that include suppression of ovulation, increased viscosity of the cervical mucus, and alterations in the endometrium.

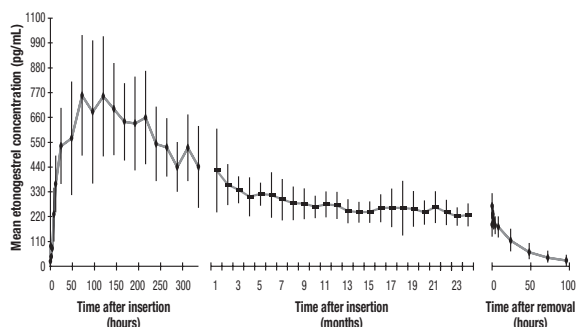
### Pharmacokinetics

#### Absorption

After subdermal insertion of IMPLANON, ENG is released into the circulation and is approximately 100% bioavailable.

The mean peak serum concentrations in 3 pharmacokinetic studies ranged between 781 and 894 pg/mL and were reached within the first few weeks after insertion. The mean serum ENG concentration decreases gradually over time declining to 192 to 261 pg/mL at 12 months (n=41), 154 to 194 pg/mL at 24 months (n=35), and 156 to 177 pg/mL at 36 months (n=17). The pharmacokinetic profile of IMPLANON from 1 of 3 pharmacokinetic studies is shown in **Figure 2**.

**FIGURE 2: Mean Serum Concentration-time Profile of ENG During 2 Years of IMPLANON Use and After Removal in 20 Healthy Women**



### Distribution

The apparent volume of distribution averages about 201 L. ENG is approximately 32% bound to sex hormone binding globulin (SHBG) and 66% bound to albumin in blood.

## IMPLANON® (etonogestrel implant)

### Metabolism

*In vitro* data shows that ENG is metabolized in liver microsomes by the cytochrome P450 3A4 isoenzyme. The biological activity of ENG metabolites is unknown.

### Excretion

The elimination half-life of ENG is approximately 25 hours. Excretion of ENG and its metabolites, either as free steroid or as conjugates, is mainly in urine and to a lesser extent in feces. After removal of IMPLANON, ENG concentrations decreased below sensitivity of the assay by 1 week.

### Special Populations

#### Overweight Women

The effectiveness of IMPLANON in overweight women has not been defined because women who weighed more than 130% of their ideal body weight were not studied. However, serum concentrations of ENG are inversely related to body weight and decrease with time after insertion. It is therefore possible that, with time, IMPLANON may be less effective in overweight women, especially in the presence of other factors that decrease etonogestrel concentrations such as concomitant use of hepatic enzyme inducers.

#### Race

No formal studies were conducted to evaluate the effect of race on the pharmacokinetics of IMPLANON.

#### Hepatic Insufficiency

No formal studies were conducted to evaluate the effect of hepatic disease on the pharmacokinetics of IMPLANON. However, ENG is metabolized by the liver, and therefore, use in patients with active liver disease is contraindicated.

#### Renal Insufficiency

No formal studies were conducted to evaluate the effect of renal disease on the pharmacokinetics of IMPLANON.

## INDICATIONS AND USAGE

IMPLANON® (etonogestrel implant) is indicated for women for the prevention of pregnancy. IMPLANON is a long-acting (up to 3 years), reversible, contraceptive method. IMPLANON must be removed by the end of the third year and may be replaced by a new IMPLANON at the time of removal, if continued contraceptive protection is desired.

In clinical trials involving 923 subjects and 1854 women-years of IMPLANON use, the total exposure in 28-day cycles by year was

- Year 1: 10,867 cycles
- Year 2: 8595 cycles
- Year 3: 3492 cycles

The clinical trials excluded women who

- Weighed more than 130% of their ideal body weight
- Were chronically taking medications that induce liver enzymes

Among women aged 18 to 35 years of age at entry, 6 pregnancies during 20,648 cycles of use were reported. Two pregnancies occurred in each of Years 1, 2, and 3. Each conception was likely to have occurred shortly before or within 2 weeks after IMPLANON removal. With these 6 pregnancies, the cumulative Pearl Index was 0.38 pregnancies per 100 women-years of use. The efficacy of IMPLANON does not depend on patient self-administration. IMPLANON may be less effective in women who are overweight or who are taking medications that induce liver enzymes (see **CLINICAL PHARMACOLOGY, Special Populations, Overweight Women, and PRECAUTIONS, Drug Interactions** sections).

The following table shows pregnancy rates in the first year of use for other contraceptive methods.

**Percentage of Women Experiencing an Unintended Pregnancy During the First Year of Typical and Perfect Use of Contraception and the Percentage Continuing Use at the End of the First Year: United States**

Method (1)	% of Women Experiencing an Unintended Pregnancy within the First Year of Use		% of Women Continuing Use at 1 Year* (4)
	Typical Use† (2)	Perfect Use‡ (3)	
Chance§	85	85	
Spermicides	26	6	40

\* Among couples attempting to avoid pregnancy, the percentage who continue to use a method for 1 year.

† Among *typical* couples who initiate use of a method (not necessarily for the first time), the percentage who experience an accidental pregnancy during the first year if they do not stop use for any other reason.

‡ Among couples who initiate use of a method (not necessarily for the first time) and who use it *perfectly* (both consistently and correctly), the percentage who experience an accidental pregnancy during the first year if they do not stop use for any other reason.

§ The percents becoming pregnant in columns (2) and (3) are based on data from populations where contraception is not used and from women who cease using contraception in order to become pregnant. Among such populations, about 89% become pregnant within 1 year. This estimate was lowered slightly (to 85%) to represent the percent who would become pregnant within 1 year among women now relying on reversible methods of contraception if they abandoned contraception altogether.

|| Foams, creams, gels, vaginal suppositories, and vaginal film.

**Percentage of Women Experiencing an Unintended Pregnancy  
During the First Year of Typical and Perfect Use of Contraception and  
the Percentage Continuing Use at the End of the First Year: United States (cont)**

Method (1)	% of Women Experiencing an Unintended Pregnancy within the First Year of Use		% of Women Continuing Use at 1 Year*
	Typical Use† (2)	Perfect Use‡ (3)	(4)
Periodic abstinence	25		63
Calendar		9	
Ovulation Method		3	
Sympto-Thermal <sup>¶</sup>		2	
Post-Ovulation		1	
Cap <sup>#</sup>			
Parous Women	40	26	42
Nulliparous Women	20	9	56
Sponge			
Parous Women	40	20	42
Nulliparous Women	20	9	56
Diaphragm <sup>#</sup>	20	6	56
Withdrawal	19	4	
Condom**			
Female (Reality)	21	5	56
Male	14	3	61
Pill	5		71
Progestin Only		0.5	
Combined		0.1	
IUD			
Progesterone T	2.0	1.5	81
Copper T 380A	0.8	0.6	78
LNg 20	0.1	0.1	81
Depo-Provera	0.3	0.3	70
Norplant & Norplant-2	0.05	0.05	88
Female sterilization	0.5	0.5	100
Male sterilization	0.15	0.10	100

Emergency Contraceptive Pills: Treatment initiated within 72 hours after unprotected intercourse reduces the risk of pregnancy by at least 75%.<sup>††</sup>

Lactation Amenorrhea Method: LAM is a highly effective, temporary method of contraception.<sup>‡‡</sup>

Adapted from Hatcher et al., *Contraceptive Technology*, 17<sup>th</sup> Revised Edition. New York, NY: Irvington Publishers, 1998.

\* Among couples attempting to avoid pregnancy, the percentage who continue to use a method for 1 year.

† Among *typical* couples who initiate use of a method (not necessarily for the first time), the percentage who experience an accidental pregnancy during the first year if they do not stop use for any other reason.

‡ Among couples who initiate use of a method (not necessarily for the first time) and who use it *perfectly* (both consistently and correctly), the percentage who experience an accidental pregnancy during the first year if they do not stop use for any other reason.

¶ Cervical mucus (ovulation) method supplemented by calendar in the pre-ovulatory and basal body temperature in the post-ovulation phases.

# With spermicidal cream or jelly.

\*\* Without spermicides.

†† The treatment schedule is 1 dose within 72 hours after unprotected intercourse, and a second dose 12 hours after the first dose. The FDA has declared the following brands of oral contraceptives to be safe and effective for emergency contraception: Ovral (1 dose is 2 white pills), Alesse (1 dose is 5 pink pills), Nordette or Levlen (1 dose is 4 yellow pills).

‡‡ However, to maintain effective protection against pregnancy, another method of contraception must be used as soon as menstruation resumes, the frequency or duration of breast feeds is reduced, bottle feeds are introduced, or the baby reaches 6 months of age.

## CONTRAINDICATIONS

IMPLANON® (etonogestrel implant) should not be used in women who have

- Known or suspected pregnancy
- Current or past history of thrombosis or thromboembolic disorders
- Hepatic tumors (benign or malignant), active liver disease
- Undiagnosed abnormal genital bleeding
- Known or suspected carcinoma of the breast or personal history of breast cancer
- Hypersensitivity to any of the components of IMPLANON

## WARNINGS

A. WARNINGS BASED ON EXPERIENCE WITH IMPLANON® (etonogestrel implant) AND OTHER PROGESTIN-ONLY CONTRACEPTIVES

### 1. Complications of Insertion and Removal

**IMPLANON should be inserted subdermally so that it is palpable after insertion. Failure to insert IMPLANON properly may go unnoticed unless the implant is palpated immediately after insertion. Deep insertions may lead to difficult or impos-**

**sible removals. Failure to remove IMPLANON may result in infertility, ectopic pregnancy, or inability to stop a drug-related adverse event. Undetected failure to insert IMPLANON may lead to an unintended pregnancy (see INSTRUCTIONS FOR INSERTION AND REMOVAL).**

In clinical trials, 1.0% of patients had complications at implant insertion and 1.7% had complications at implant removal. Complications expected of a minor surgical procedure, such as pain, paresthesias, bleeding, hematoma, scarring or infection, have been reported. Occasionally in postmarketing use, implant insertions have failed because the implant fell out of the needle or remained in the needle during insertion. Implant removals may be difficult because the implant is deep, not palpable, encased in fibrous tissue, or has migrated. Implants have broken during difficult removals. Deep insertions may result in the need for a surgical procedure in an operating room in order to remove IMPLANON. Any of the possible complications of surgery may occur. When IMPLANON is inserted too deeply (intramuscular or in the fascia), this may cause neural or vascular damage. Too deep insertions have been associated with paraesthesia (due to neural damage), migration of the implant (due to intramuscular or fascial insertion), and in rare cases with intravascular insertion. In post-marketing use there have been cases of failure to localize and remove the implant, probably due to deep insertion. There has been 1 case of an intravascular insertion reported postmarketing which led to inability to remove the implant.

If infection develops at the insertion site, start suitable treatment. If infection persists, remove IMPLANON. Incomplete insertions or infections may lead to expulsion.

### 2. Ectopic Pregnancies

Be alert to the possibility of an ectopic pregnancy among patients using IMPLANON who become pregnant or complain of lower abdominal pain. Although ectopic pregnancies should be uncommon among patients using IMPLANON, a pregnancy that occurs in a patient using IMPLANON may be more likely to be ectopic than a pregnancy occurring in a patient using no contraception.

### 3. Bleeding Irregularities

Patients who use IMPLANON are likely to have changes in their vaginal bleeding patterns, which are often unpredictable. These may include changes in bleeding frequency or duration, or amenorrhea. Patients should be counseled regarding unpredictable bleeding irregularities so that they know what to expect. Abnormal bleeding should be evaluated as needed to exclude pathologic conditions or pregnancy.

In clinical trials, bleeding changes were the single most common reason for stopping treatment with IMPLANON (11.1%, or 105 of 942 patients using IMPLANON). Most patients stopped treatment with IMPLANON because of irregular bleeding (10.8%), but some stopped because of amenorrhea (0.3%). In these studies, patients using IMPLANON had an average of 17.7 days of bleeding or spotting every 90 days (based on 3315 intervals of 90 days recorded by 780 patients). The percentages of patients having 0, 1 to 7, 8 to 21, or >21 days of spotting or bleeding over a 90-day interval while using IMPLANON is shown in the following table.

**Percentages of Patients with 0, 1 to 7, 8 to 21, or >21 Days of  
Spotting or Bleeding Over a 90-Day Interval While Using IMPLANON**

Total Days of Spotting or Bleeding	Percentage of Patients		
	Treatment Days 91-180 (N=566)	Treatment Days 270-360 (N=554)	Treatment Days 640-730 (N=547)
0 days	19%	24%	17%
1-7 days	15%	13%	12%
8-21 days	30%	30%	37%
>21 days	36%	33%	35%

Bleeding patterns observed with use of IMPLANON for up to 2 years, and the proportion of 90-day intervals with these bleeding patterns, are summarized in the following table.

**Bleeding Patterns Using IMPLANON During the First 2 Years of Use**

Bleeding Patterns	Definitions	%
Infrequent	Less than 3 bleeding and/or spotting episodes in 90 days (excluding amenorrhea)	33.6
Amenorrhea	No bleeding and/or spotting in 90 days	22.2
Prolonged	Any bleeding and/or spotting episode lasting more than 14 days in 90 days	17.7
Frequent	More than 5 bleeding and/or spotting episodes in 90 days	6.7

% = Percentage of 90-day intervals with this pattern.

Based on 3315 recording periods of 90 day's duration in 780 women, excluding the first 90 days after implant insertion.

### 4. Interaction With Anti-Epileptic and Other Drugs

IMPLANON is not recommended for women who chronically take drugs that are potent hepatic enzyme inducers because etonogestrel levels may be substantially reduced in these women (see also **PRECAUTIONS, Drug Interactions** section).

**5. Ovarian Cysts**

If follicular development occurs, atresia of the follicle is sometimes delayed, and the follicle may continue to grow beyond the size it would attain in a normal cycle. Generally, these enlarged follicles disappear spontaneously. Rarely, they can require surgery.

**6. Thrombosis**

There have been postmarketing reports of serious thromboembolic events, including cases of pulmonary emboli (some fatal) and strokes, in patients using IMPLANON. IMPLANON should be removed in the event of a thrombosis. Consider removal of IMPLANON in case of long-term immobilization due to surgery or illness. Women with a history of thromboembolic disorders should be made aware of the possibility of a recurrence (see also **WARNINGS, WARNINGS BASED ON EXPERIENCE WITH COMBINATION (PROGESTIN PLUS ESTROGEN) ORAL CONTRACEPTIVES** section).

**B. WARNINGS BASED ON EXPERIENCE WITH COMBINATION (PROGESTIN PLUS ESTROGEN) ORAL CONTRACEPTIVES****1. Thromboembolic Disorders and Other Vascular Problems**

Thromboembolism: Epidemiological investigations have associated the use of combination hormonal contraceptives with an increased incidence of venous thromboembolism (VTE, deep venous thrombosis, retinal vein thrombosis, and pulmonary embolism).

The use of combination hormonal contraceptives is associated with increased risks of several serious conditions including myocardial infarction, thromboembolism, and stroke, although the risk of serious morbidity or mortality is very small in healthy women without underlying risk factors. The risk increases significantly in the presence of other underlying risk factors such as hypertension, hyperlipidemias, obesity, and diabetes.

**2. Cigarette Smoking**

Cigarette smoking increases the risk of serious cardiovascular side effects from the use of combination hormonal contraceptives. This risk increases with age and with heavy smoking (15 or more cigarettes per day) and is quite marked in women over 35 years old who smoke. While this is believed to be an estrogen-related effect, it is not known whether a similar risk exists with progestin-only methods. However, patients should be advised not to smoke.

**3. Elevated Blood Pressure**

An increase in blood pressure has been reported in women taking combination hormonal contraceptives, and this increase is more likely with continued use and with those users who are older. Studies have shown that the incidence of hypertension increases with increasing concentrations of progestins.

Women with a history of hypertension-related diseases or renal disease should be discouraged from using hormonal contraceptives. If women with hypertension elect to use hormonal contraceptives, they should be monitored closely. If sustained hypertension develops during the use of hormonal contraceptives, or if a significant increase in blood pressure does not respond adequately to antihypertensive therapy, hormonal contraceptives should be discontinued.

For most women, elevated blood pressure will return to normal after stopping hormonal contraceptives, and there is no difference in the occurrence of hypertension between ever- and never-users.

**4. Carcinoma of the Breast and Reproductive Organs**

Women with breast cancer should not use hormonal contraceptives because breast cancer may be hormonally sensitive.

The risk of having breast cancer diagnosed may be slightly increased among current and recent users of combination oral contraceptives. However, after combination oral contraceptive discontinuation, this excess risk appears to decrease over time, and within 10 years after cessation the increased risk disappears. Some studies report an increased risk with duration of use while other studies do not, and no consistent relationships have been found with dose or type of steroid. Some studies have found a small increase in risk for women who first used combination oral contraceptives before age 20. Most studies show a similar pattern of risk with combination oral contraceptive use regardless of a woman's reproductive history or her family breast cancer history.

In addition, breast cancers diagnosed in current or ever oral contraceptive users may be less clinically advanced than in never-users.

Some studies suggest that oral contraceptive use has been associated with an increase in the risk of cervical intraepithelial neoplasia in some populations of women. However, there continues to be controversy about the extent to which such findings may be due to differences in sexual behavior and other factors.

In spite of many studies on the relationship between combination oral contraceptive use and breast and cervical cancers, a cause-and-effect relationship has not been established.

**5. Hepatic Neoplasia**

Benign hepatic adenomas have been associated with the use of combination oral contraceptives, although the incidence of benign tumors is rare in the United States.

Indirect calculations have estimated the attributable risk to be in the range of 3.3 cases/100,000 for users, a risk that increases after 4 or more years of use. Rupture of benign hepatic adenomas may cause death through intra-abdominal hemorrhage. Studies from Britain have shown an increased risk of developing hepatocellular carcinoma in long-term (>8 years) oral contraceptive users. However, these cancers are extremely rare in the US and the attributable risk (the excess incidence) of liver cancers in oral contraceptive users approaches less than 1 per million users.

**6. Gallbladder Disease**

Earlier studies have reported an increased lifetime relative risk of gallbladder surgery in users of combination oral contraceptives and estrogens. More recent studies, however, have shown that the relative risk of developing gallbladder disease among combination oral contraceptive users may be minimal. The recent findings of minimal risk may be related to the use of combination oral contraceptive formulations containing lower doses of estrogens and progestins.

**PRECAUTIONS****1. General**

**Women should be informed that this product does not protect against infection from HIV (the virus that causes AIDS) or other sexually transmitted diseases.**

**IMPORTANT: Pregnancy must be excluded before inserting IMPLANON® (etonogestrel implant).**

**2. Physical Examination and Follow-up**

A complete medical evaluation, including history and physical examination and relevant laboratory tests, should be performed prior to IMPLANON insertion or reinsertion. It is good medical practice for patients using IMPLANON to have regular physical examinations. In case of undiagnosed, persistent, or recurrent abnormal vaginal bleeding, appropriate measures should be conducted to rule out malignancy. Women with a family history of breast cancer or who have breast nodules should be monitored with particular care.

**3. Information for the Patient**

Provide your patient with a copy of the Patient Labeling and ensure that she understands the information in the Patient Labeling before insertion and removal. A USER CARD and consent form are included in the packaging. Have the patient complete a consent form and retain it in your records. The USER CARD should be filled out and given to the patient after IMPLANON insertion so that she will have a record of the location of IMPLANON and when IMPLANON should be removed.

**4. Weight Gain**

In clinical studies, mean weight gain in US IMPLANON users was 2.8 pounds after 1 year and 3.7 pounds after 2 years. How much of the weight gain was related to IMPLANON is unknown. In studies, 2.3% of IMPLANON users reported weight gain as the reason for having IMPLANON removed.

**5. Carbohydrate and Lipid Metabolic Effects**

IMPLANON may induce mild insulin resistance and small changes in glucose concentrations of unknown clinical significance. Women with diabetes or impaired glucose tolerance should be carefully observed while using IMPLANON.

Women who are being treated for hyperlipidemias should be followed closely if they elect to use hormonal contraceptives. Some progestins may elevate LDL levels and may render the control of hyperlipidemias more difficult.

**6. Liver Function**

If jaundice develops in any patient using IMPLANON, remove IMPLANON. The hormone in IMPLANON may be poorly metabolized in patients with impaired liver function.

**7. Depression**

Women with a history of depression should be carefully observed. Consideration should be given to removing IMPLANON in patients who become significantly depressed.

**8. Contact Lenses**

Contact lens wearers who develop visual changes or changes in lens tolerance should be assessed by an ophthalmologist.

**9. Drug Interactions****Changes in Contraceptive Effectiveness Associated with Coadministration of Other Drugs****a. Anti-Infective Agents and Anticonvulsants**

IMPLANON is not recommended for women who require chronic use of drugs that are potent inducers of hepatic enzymes because IMPLANON is likely to be less effective for these women.

Contraceptive effectiveness may be reduced when hormonal contraceptives are administered with some antibiotics, antifungals, anticonvulsants, and other drugs that increase the metabolism of contraceptive steroids. This could result in an unintended pregnancy or breakthrough bleeding. Examples include: barbiturates, griseofulvin, rifampin, phenylbutazone, phenytoin, carbamazepine, felbamate, oxcarbazepine, topiramate, and modafinil. Patients should use an additional nonhormonal contraceptive method when taking medications that may decrease the efficacy of hormonal contraceptives.

**b. Anti-HIV Protease Inhibitors**

Several of the anti-HIV protease inhibitors have been studied with coadministration of combination oral contraceptives; significant changes (increase and decrease) in the mean area under the curve (AUC) of the estrogen and progestin have been noted in some cases. The efficacy and safety of combination oral contraceptive products may be affected with coadministration of anti-HIV protease inhibitors; it is unknown whether this applies to IMPLANON. Healthcare providers should refer to the labeling of the individual anti-HIV protease inhibitors for further drug-drug interaction information.

**c. Herbal Products**

Herbal products containing St. John's wort (*Hypericum perforatum*) may induce hepatic enzymes and p-glycoprotein transporter and may reduce the effectiveness of contraceptive steroids.

**Increase in Plasma Hormone Levels Associated with Coadministered Drugs**

Inhibitors of hepatic enzymes such as itraconazole or ketoconazole may increase plasma hormone levels.

**10. Interactions with Laboratory Tests**

Certain endocrine tests may be affected by IMPLANON use

- Sex hormone-binding globulin concentrations may be decreased for the first 6 months after IMPLANON insertion followed by a gradual recovery.
- Thyroxine concentrations may initially be slightly decreased followed by gradual recovery to baseline.

**11. Carcinogenesis, Mutagenesis, Impairment of Fertility**

In a 24-month carcinogenicity study in rats with subdermal implants releasing 10 and 20 mcg etonogestrel (ENG) per day (equal to approximately 1.8-3.6 times the systemic steady state exposure of women using IMPLANON), no drug-related carcinogenic potential was observed. ENG was not genotoxic in the *in vitro* Ames/Salmonella reverse mutation assay, the chromosomal aberration assay in Chinese hamster ovary cells or in the *in vivo* mouse micronucleus test. Fertility returned after withdrawal from treatment.

**12. Pregnancy**

IMPLANON is not indicated for use during pregnancy (see **CONTRAINDICATIONS**). Teratology studies have been performed in rats and rabbits, respectively, using oral administration up to 390 and 790 times the human IMPLANON dose (based upon body surface) and revealed no evidence of fetal harm due to ENG exposure.

Studies have revealed no increased risk of birth defects in women who have used combination oral contraceptives before pregnancy or during early pregnancy. There is no evidence that the risk associated with IMPLANON is different from that of combination oral contraceptives.

IMPLANON should be removed if maintaining a pregnancy.

**13. Nursing Mothers**

Based on limited data, IMPLANON may be used during lactation after the fourth postpartum week. Use of IMPLANON before the fourth postpartum week has not been studied. Small amounts of ENG are excreted in breast milk. During the first months after IMPLANON insertion, when maternal blood levels of ENG are highest, about 100 ng of ENG may be ingested by the child per day based on an average daily milk ingestion of 658 mL. Based on daily milk ingestion of 150 mL/kg, the mean daily infant ENG dose 1 month after insertion of IMPLANON is about 2.2% of the weight-adjusted maternal daily dose, or about 0.2% of the estimated absolute maternal daily dose. The health of breastfed infants whose mothers began using IMPLANON during the fourth to eighth week postpartum (n=38) was evaluated in a comparative study with infants of mothers using a nonhormonal IUD (n=33). They were breastfed for a mean duration of 14 months and followed up to 36 months of age. No significant effects and no differences between the groups were observed on the physical and psychomotor development of these infants. No differences between groups in the production or quality of breast milk were detected.

Healthcare providers should discuss both hormonal and nonhormonal contraceptive options, as steroids may not be the initial choice for these patients.

**14. Return to Ovulation**

In clinical trials, pregnancies occurred as early as during the first week after removal of IMPLANON. Therefore, a patient should restart contraception immediately after removal of IMPLANON if she still needs to prevent pregnancy.

**15. Fluid Retention**

Steroid contraceptives may cause some degree of fluid retention. They should be prescribed with caution, and only with careful monitoring, in patients with conditions which might be aggravated by fluid retention. It is unknown if IMPLANON causes fluid retention.

**16. Pediatric Use**

Safety and efficacy of IMPLANON have been established in women of reproductive age. Safety and efficacy are expected to be the same for postpubertal adolescents. However, no clinical studies have been conducted in women less than 18 years of age. Use of this product before menarche is not indicated.

**17. Geriatric Use**

This product has not been studied in women over 65 years of age and is not indicated in this population.

**ADVERSE REACTIONS**

See **WARNINGS** and **PRECAUTIONS** for additional important adverse events.

In clinical trials including 942 subjects, bleeding irregularities were the most common adverse event causing discontinuation of IMPLANON® (etonogestrel implant) (see following table).

**Adverse Events Leading to Discontinuation of Treatment in 1% or More of Subjects in Clinical Trials**

Adverse Event	All Studies N=942
Bleeding Irregularities*	11.0%
Emotional Lability†	2.3%
Weight Increase	2.3%
Headache	1.6%
Acne	1.3%
Depression‡	1.0%

\* Includes "frequent", "heavy", "prolonged", "spotting", and other patterns of bleeding irregularity.

† Among US subjects, 6.1% experienced emotional lability that led to discontinuation.

‡ Among US subjects, 2.4% experienced depression that led to discontinuation.

Adverse events that were reported by more than 5% of subjects in clinical trials appear in the following table.

**Adverse Events Reported in More than 5% of Subjects in Clinical Trials\***

Adverse Event	All Studies N=942
Headache	24.9%
Vaginitis	14.5%
Weight Increase	13.7%
Acne	13.5%
Breast Pain	12.8%
Upper Respiratory Tract Infection	12.6%
Abdominal Pain	10.9%
Pharyngitis	10.5%
Leukorrhea	9.6%
Influenza-Like Symptoms	7.6%
Dizziness	7.2%
Dysmenorrhea	7.2%
Back Pain	6.8%
Emotional Lability	6.5%
Nausea	6.4%
Pain	5.6%
Nervousness	5.6%
Sinusitis	5.6%
Depression	5.5%
Insertion Site Pain	5.2%

\* List may include adverse events associated with, but unrelated to, IMPLANON use.

**Other "Less Common Adverse Events"** Reported in Less Than 5% of Subjects in Clinical Trials Include: Allergic Reaction, Alopecia, Anorexia, Anxiety, Appetite Increased, Arthralgia, Asthenia, Asthma, Breast Discharge, Breast Enlargement, Breast Fibroadenosis, Cervical Smear Test Positive, Constipation, Coughing, Crying Abnormal, Diarrhea, Dyspepsia, Dysuria, Edema, Edema Generalized, Fatigue, Fever, Flatulence, Gastritis, Hot Flashes, Hypertension, Hypoesthesia, Injection Site Reaction, Insomnia, Lactation Nonpuerperal, Libido Decreased, Migraine, Myalgia, Otitis Media, Ovarian Cyst, Pelvic Cramping, Premenstrual Tension, Pruritus, Pruritus Genital, Rash, Rhinitis, Sexual Function Abnormal, Skeletal Pain, Somnolence, Vaginal Discomfort, Vein Varicose, Vision Abnormal, Vomiting, and Weight Decrease.

Hypertrichosis has also been reported with use of progestin-only contraceptives.

Implant site complications were reported by 3.6% of subjects during any of the assessments in clinical trials. Pain was the most frequent implant site complication, reported during and/or after insertion, occurring in 2.9% of subjects. Additionally, hematoma, redness, and swelling were reported by 0.1%, 0.3%, and 0.3% of patients, respectively (see also **WARNINGS**, **WARNINGS BASED ON EXPERIENCE WITH IMPLANON AND OTHER PROGESTIN-ONLY CONTRACEPTIVES**, **Complications of Insertion and Removal** section).

**OVERDOSAGE**

Insertion of multiple rods has been reported. Overdosage may result if more than 1 IMPLANON® (etonogestrel implant) rod is in place. In case of suspected overdose, IMPLANON should be removed. It is important to remove the IMPLANON rod or other contraceptive implant(s) before inserting a new IMPLANON rod.

**DOSAGE AND ADMINISTRATION**

All healthcare providers performing insertions and/or removals of IMPLANON® (etonogestrel implant) must receive instruction and training and where appropriate, supervision prior to

inserting or removing IMPLANON. To minimize the risk of neural or vascular damage, IMPLANON should be inserted at the inner side of the nondominant upper arm about 8 to 10 cm (3-4 inches) above the medial epicondyle of the humerus. **IMPLANON should be inserted subdermally just under the skin to avoid the large blood vessels and nerves that lie deeper in the subcutaneous tissues in the sulcus between the triceps and biceps muscles** (see **INSTRUCTIONS FOR INSERTION AND REMOVAL**). IMPLANON must be inserted by the expiration date stated on the packaging. **Remove IMPLANON no later than 3 years after the date of insertion.**

#### When to Insert IMPLANON

**IMPORTANT: Rule out pregnancy before inserting IMPLANON.**

**Timing of insertion depends on the patient's recent history, as follows**

- No preceding hormonal contraceptive use in the past month**  
Counting the first day of menstruation as "Day 1", IMPLANON must be inserted between Days 1 through 5, even if the woman is still bleeding.
- Switching from a combination hormonal contraceptive**  
IMPLANON may be inserted
  - Anytime within 7 days after the last active (estrogen plus progestin) oral contraceptive tablet
  - Anytime during the 7-day ring-free period of NuvaRing® (etonogestrel/ethinyl estradiol vaginal ring)
  - Anytime during the 7-day patch-free period of a transdermal contraceptive system
- Switching from a progestin-only method**  
There are several types of progestin-only methods. IMPLANON insertion must be performed as follows
  - Any day of the month when switching from a progestin-only pill, do not skip any days between the last pill and insertion of IMPLANON
  - On the same day as contraceptive implant removal
  - On the same day as removal of a progestin-containing IUD
  - On the day when the next contraceptive injection would be due
- Following first trimester abortion or miscarriage**
  - IMPLANON may be inserted immediately following a complete first trimester abortion. If IMPLANON is not inserted within 5 days following a first trimester abortion, follow the instructions under "No preceding hormonal contraceptive use in the past month"
- Following delivery or a second trimester abortion**
  - IMPLANON may be inserted between 21 to 28 days postpartum if not exclusively breastfeeding or between 21 to 28 days following second trimester abortion. If more than 4 weeks have elapsed, pregnancy should be excluded and **the patient should use a nonhormonal method of birth control during the first 7 days after the insertion.** If the patient is exclusively breastfeeding, insert IMPLANON after the fourth postpartum week (see **PRECAUTIONS, Nursing Mothers** section)

**If inserted as recommended above, backup contraception is not necessary. If deviating from the recommended timing of insertion, rule out pregnancy and use backup nonhormonal contraception for 7 days after IMPLANON insertion.**

#### HOW SUPPLIED

One IMPLANON® (etonogestrel implant) package consists of a single rod implant containing 68 mg etonogestrel that is 4 cm in length and 2 mm in diameter. IMPLANON is preloaded in the needle of a disposable applicator. The applicator consists of acrylonitrile-butadiene-styrene body with a stainless steel needle and a polypropylene shield. The sterile applicator containing IMPLANON is packed in a blister pack.

NDC 0052-0272-01

#### STORAGE

Store IMPLANON® (etonogestrel implant) at 25°C (77°F); excursions permitted to 15°-30°C (59°-86°F) [see USP Controlled Room Temperature]. Protect from light. Avoid storing IMPLANON in direct sunlight or at temperatures above 30°C (86°F).

**R** only

#### REFERENCES FURNISHED UPON REQUEST

#### INSTRUCTIONS FOR INSERTION AND REMOVAL

The basis for successful use and subsequent removal of IMPLANON® (etonogestrel implant) is a correct and carefully performed subdermal insertion of the single rod implant in accordance with the instructions. If the implant is placed improperly leading to deep location or migration, it will be more difficult to remove than a correctly placed subdermal implant. All healthcare providers performing insertions and removals of IMPLANON must receive instruction and training, and where appropriate, supervision prior to inserting or removing IMPLANON. Information concerning the insertion and removal of IMPLANON will be sent upon request free of charge [Telephone: 1-877-IMPLANON (1-877-467-5266)].

#### INSERTION PROCEDURE

Prior to inserting IMPLANON® (etonogestrel implant) carefully read the instructions for insertion and removal as well as the full prescribing information.

**Place IMPLANON subdermally. Both you and your patient should be able to feel IMPLANON under her skin after placement.**

Follow instructions carefully. All healthcare providers must receive training before inserting or removing IMPLANON. Proper IMPLANON insertion will facilitate removal. Correct timing of insertion is important (see **DOSAGE AND ADMINISTRATION, When to Insert IMPLANON** section). Perform a history and physical examination, including a gynecologic examination, before IMPLANON insertion. Ensure that the patient understands the risks and benefits of IMPLANON before insertion. Provide the patient with a copy of the Patient labeling included in packaging. Have the patient review and complete a consent form and maintain it with the patient's chart.

**Exclude pregnancy before insertion.**

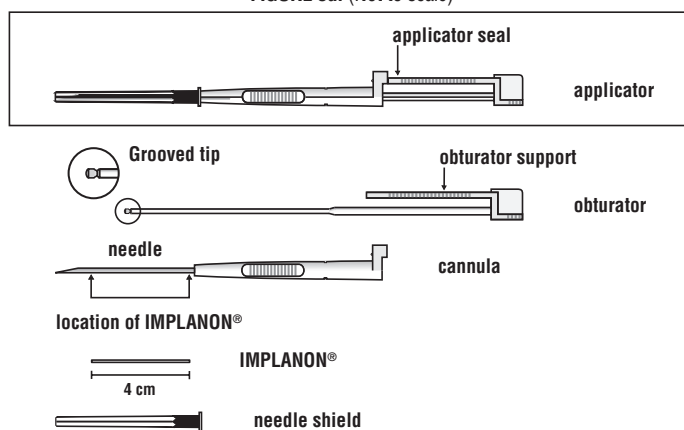
Insert IMPLANON under aseptic conditions.

The following equipment is needed for IMPLANON insertion

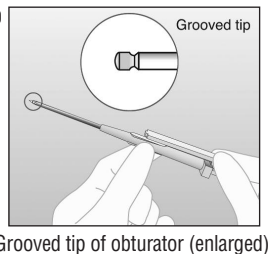
- An examination table for the patient to lie on
- Sterile surgical drapes, talc-free sterile gloves, antiseptic solution, sterile marker (optional)
- Local anesthetic, needles, and syringe
- Sterile gauze, adhesive bandage, pressure bandage

An applicator and its parts are shown below (see **Figures 3a** and **3b**).

**FIGURE 3a:** (Not to scale)



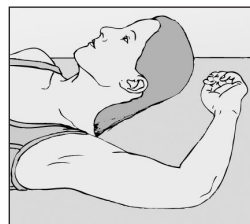
**FIGURE 3b**



**The procedure used for IMPLANON insertion is opposite from that of an injection. The obturator keeps IMPLANON in place while the cannula is retracted. The obturator must remain fixed in place while the cannula with needle is retracted from the arm. Do not push the obturator.**

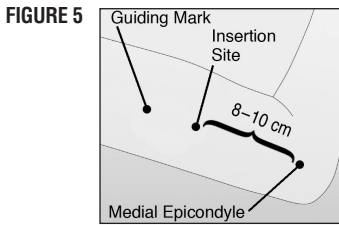
- Confirm that the patient does not have allergies to IMPLANON, as well as the antiseptic and anesthetic to be used during insertion.
- Have the patient lie on her back on the examination table with her nondominant arm flexed at the elbow and externally rotated so that her wrist is parallel to her ear or her hand is positioned next to her head (see **Figure 4**).

**FIGURE 4**

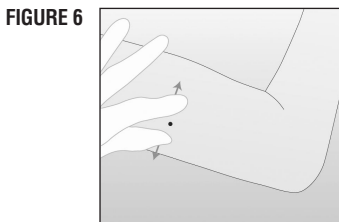


- Identify the insertion site, which is at the inner side of the nondominant upper arm about 8 to 10 cm (3-4 inches) above the medial epicondyle of the humerus (see **Figure 5**). **IMPLANON should be inserted subdermally just under the skin to avoid the large blood vessels and nerves that lie deeper in the subcutaneous tissue of the sulcus between the biceps and triceps muscles.**

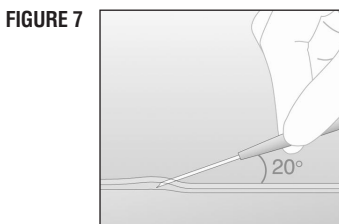
- Mark the insertion site with a sterile marker. Make 2 marks: first, mark the spot where the IMPLANON rod will be inserted, and second, mark a spot a few centimeters proximal to the first mark (see **Figure 5**). This second mark will later serve as a direction guide during IMPLANON insertion.



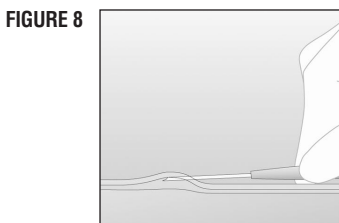
- Clean the insertion site with an antiseptic solution.
- Anesthetize the insertion area (for example, with anesthetic spray or by injecting 2 cc of 1% lidocaine just under the skin along the planned insertion tunnel).
- Carefully remove the IMPLANON applicator from its blister. Keep the shield on the needle and look for the IMPLANON rod, seen as a white cylinder inside the needle tip.
- If you don't see the IMPLANON rod, tap the top of the needle shield against a firm surface to bring the implant into the needle tip.
- Following visual confirmation, lower the IMPLANON rod back into the needle by tapping it back into the needle tip. Then remove the needle shield, while holding the applicator upright.
- Note that IMPLANON can fall out of the needle.** Therefore, after you remove the needle shield, keep the applicator in the upright position until the moment of insertion.
- Keep the IMPLANON needle and rod sterile. If contamination occurs, use a new package of IMPLANON with a new sterile applicator.
- Apply counter-traction to the skin around the proposed insertion (see **Figure 6**).



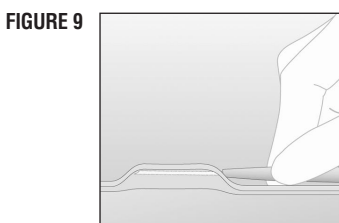
- At a slight angle (not greater than 20°), insert **only** the tip of the needle with the beveled side up into the insertion site (see **Figure 7**).



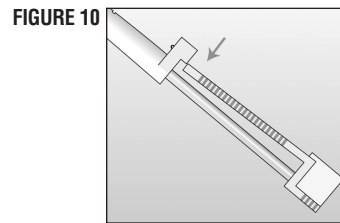
- Lower the applicator to a horizontal position. Lift the skin up with the tip of the needle, but **keep the needle in the subdermal connective tissue** (see **Figure 8**).



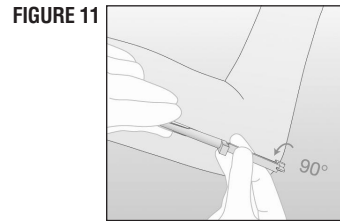
- While “tenting” (lifting) the skin, gently insert the needle to its full length. Keep the needle parallel to the surface of the skin during insertion (see **Figure 9**).



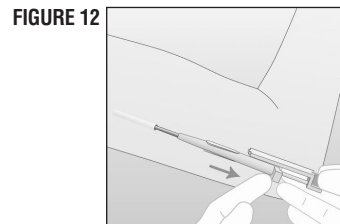
- If **IMPLANON is placed too deeply, the removal process can be difficult or impossible. If the needle is not inserted to its full length, the implant may protrude from the insertion site and fall out.**
- Break the seal of the applicator by pressing the obturator support (see **Figure 10**).



- Turn the obturator 90° in either direction with respect to the needle (see **Figure 11**).

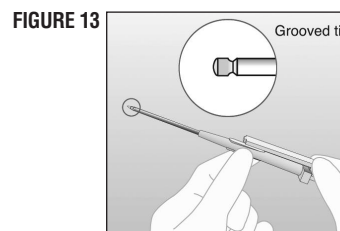


- While holding the obturator fixed in place on the arm, fully retract the cannula (see **Figure 12**). **Note: This procedure is opposite from an injection. Do not push the obturator. By holding the obturator fixed in place on the arm and fully retracting the cannula, IMPLANON will be left in its correct subdermal position. Do not simultaneously retract the obturator and cannula from the patient's arm.**



In this figure, the right hand is holding the obturator in place while the left hand is retracting the cannula.

- Confirm that IMPLANON has been inserted by checking the tip of needle for the absence of IMPLANON. After IMPLANON insertion, the grooved tip of the obturator will be visible inside the needle (see **Figure 13**).



- Always verify the presence of IMPLANON in the patient's arm immediately after insertion by palpation.** By palpating both ends of the implant, you should be able to confirm the presence of the 4-cm rod.
- Place a small adhesive bandage over the insertion site. Request that the patient palpate IMPLANON.
- If you cannot feel IMPLANON as a 4-cm long rod, confirm its presence using other methods. Suitable methods to locate IMPLANON are: ultrasound (US) with a high-frequency linear array transducer (10 MHz or greater) or magnetic resonance imaging (MRI). Please note that the IMPLANON rod is not radio-opaque and cannot be seen by X-ray or CT scan. If ultrasound and MRI fail, call 1-877-IMPLANON (1-877-467-5266) for information on the procedure for measuring ENG blood levels. **Until you confirm proper IMPLANON insertion, your patient must use a nonhormonal contraceptive method.**
- Apply a pressure bandage with sterile gauze to minimize bruising. The patient may remove the pressure bandage in 24 hours and the small bandage over the insertion site in 3 to 5 days.
- Complete the USER CARD and give it to the patient to keep. Also, complete the Patient Chart Label and affix it to the patient's medical record.
- The applicator is for single use only. Dispose of the applicator in accordance with the Center for Disease Control and Prevention guidelines for handling of hazardous waste.

**REMOVAL PROCEDURE**

Before initiating the removal procedure, the healthcare provider may consult the USER CARD that is kept by the patient and/or the Patient Chart Label. The arm in which IMPLANON® (etonogestrel implant) is located should be indicated on the USER CARD and the Patient Chart Label. IMPLANON should have been inserted in the medial aspect of the upper nondominant arm. **Prior to removing IMPLANON, carefully read the instructions for removal. Find IMPLANON by palpation. If IMPLANON cannot be palpated, use either ultrasound with a high-frequency linear array transducer (10 MHz or greater) or magnetic resonance imaging to localize the implant.** Consider conducting difficult removals with ultrasound guidance. Only remove a nonpalpable implant once the location of IMPLANON has been established. If these imaging methods fail, call 1-877-IMPLANON (1-877-467-5266) for further instructions.

There have been occasional reports of migration of the implant; usually this involves minor movement relative to the original position. This may complicate localization of the implant by palpation, ultrasound, or magnetic resonance imaging, and removal may require a larger incision and more time.

Exploratory surgery without knowledge of the exact location of the implant is strongly discouraged. Removal of deeply inserted implants should be conducted with caution, in order to prevent damage to deeper neural or vascular structures in the arm, and be performed by healthcare providers familiar with the anatomy of the arm.

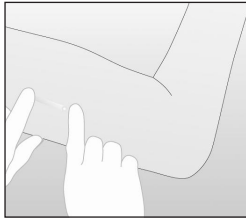
The patient's position for removal is similar to the position for insertion. Use aseptic technique.

The following equipment is needed for removal

- An examination table for the patient to lie on
- Sterile surgical drapes, talc-free sterile gloves, antiseptic solution, sterile marker (optional)
- Local anesthetic, needles, and syringe
- Sterile scalpel, forceps (straight and curved mosquito)
- Skin closure, sterile gauze, adhesive bandage, and pressure bandages

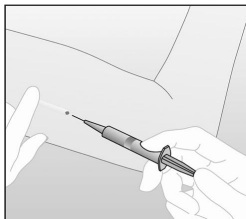
1. IMPLANON must only be removed by a healthcare provider who has been instructed and trained in the IMPLANON removal technique.
2. The arm in which IMPLANON is located should be indicated on the USER CARD and the Patient Chart Label. IMPLANON should be in the medial aspect of the upper nondominant arm.
3. After confirming that the patient does not have any allergies to the antiseptic, wash the patient's arm and apply an antiseptic. Locate IMPLANON by palpation and mark the end closest to the elbow, for example, with a sterile marker (see **Figure a**).

**FIGURE a**



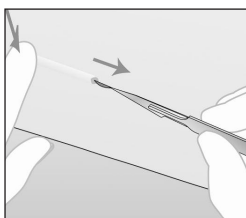
4. After determining the absence of allergies to the anesthetic agent or related drugs, anesthetize the arm, for example, with 0.5 to 1 cc 1% lidocaine at the site where the incision will be made (near the tip of IMPLANON that is closest to the elbow) (see **Figure b**). Be sure to inject the local anesthetic **under** IMPLANON to keep the implant close to the skin surface.

**FIGURE b**



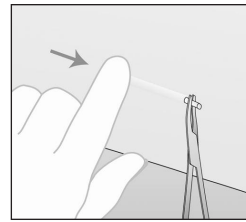
5. Make a 2- to 3-mm incision in the longitudinal direction of the arm at the tip of the implant closest to the elbow (see **Figure c**).

**FIGURE c**



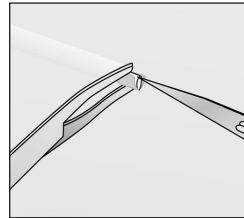
6. Gently push IMPLANON toward the incision until the tip is visible. Grasp the implant with forceps (preferably curved mosquito forceps) and pull it out gently (see **Figure d**).

**FIGURE d**

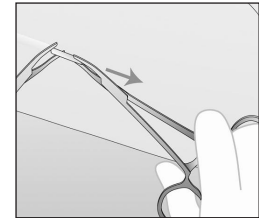


7. If IMPLANON is encapsulated, make an incision into the tissue sheath and then remove IMPLANON with the forceps (see **Figures e** and **f**).

**FIGURE e**

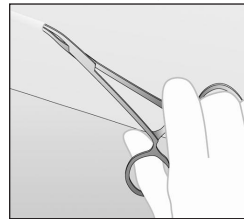


**FIGURE f**

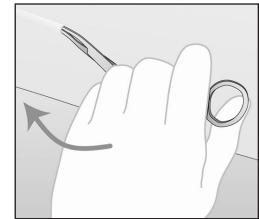


8. If the tip of the implant is still not visible after gently pushing it towards the incision (as in step 6), gently insert a forceps into the incision and grasp the implant (see **Figures g** and **h**). Turn the forceps around (see **Figure h**).

**FIGURE g**

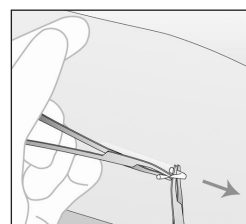


**FIGURE h**



9. With a second forceps carefully dissect the tissue around IMPLANON and then remove IMPLANON (see **Figure i**). Be sure to remove the IMPLANON rod entirely. Confirm that the entire rod, which is 4 cm long, has been removed by measuring its length.

**FIGURE i**



If the patient would like to continue using IMPLANON, insert a new IMPLANON rod immediately after the old IMPLANON rod is removed. The new IMPLANON can be inserted in the same arm, and through the same incision, or a new IMPLANON can be inserted in the other arm. If the patient does not wish to continue using IMPLANON and does not want to become pregnant, recommend another contraceptive method.

10. After removing IMPLANON, close the incision with a butterfly closure and apply an adhesive bandage.
11. Apply a pressure bandage with sterile gauze to minimize bruising.

Manufactured by N.V. Organon, Oss, The Netherlands.  
 Distributed by Schering Corporation, a subsidiary of  
 Schering-Plough Corporation, Kenilworth, NJ 07033 USA.



# IMPLANON® (etonogestrel implant)

68 mg

For Subdermal Use Only

**Rx only**

**IMPLANON® does not protect against infection from HIV (the virus that causes AIDS) or other sexually transmitted diseases.**

Read this leaflet carefully and have your healthcare provider answer all of your questions before you decide to use IMPLANON.

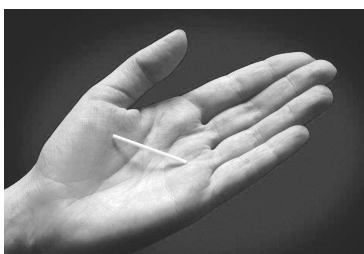
**What is the most important information I should know about IMPLANON®?**

After you receive IMPLANON, check that it is in place by pressing your fingertips over the skin in your arm where IMPLANON was placed. You should be able to feel the IMPLANON rod. If IMPLANON is not placed properly, it may not prevent pregnancy or it may be difficult or impossible to remove.

The most common side effect of IMPLANON is a change in your menstrual periods. Expect your menstrual period to be irregular and unpredictable throughout the time you are using IMPLANON. You may have more bleeding, less bleeding, or no bleeding. The time between periods may vary, and in between periods you may have spotting.

**What is IMPLANON®?**

IMPLANON is a type of birth control for women. It is a flexible plastic rod the size of a matchstick that is put under the skin of your arm. IMPLANON contains a hormone called etonogestrel. You can use a single IMPLANON rod for up to 3 years. Because IMPLANON does not contain estrogen, your healthcare provider may recommend IMPLANON even if you cannot use estrogen.



**What if I need birth control for more than 3 years?**

You must have IMPLANON removed after 3 years. If you want to continue using IMPLANON, your healthcare provider can put a new IMPLANON under your skin after taking out the old one.

**What if I change my mind about birth control?**

Your healthcare provider can remove IMPLANON at any time. If you want to become pregnant after IMPLANON removal, your ability to get pregnant may return quickly. If you don't want to get pregnant, you should start another birth control method right away.

**How does IMPLANON® work?**

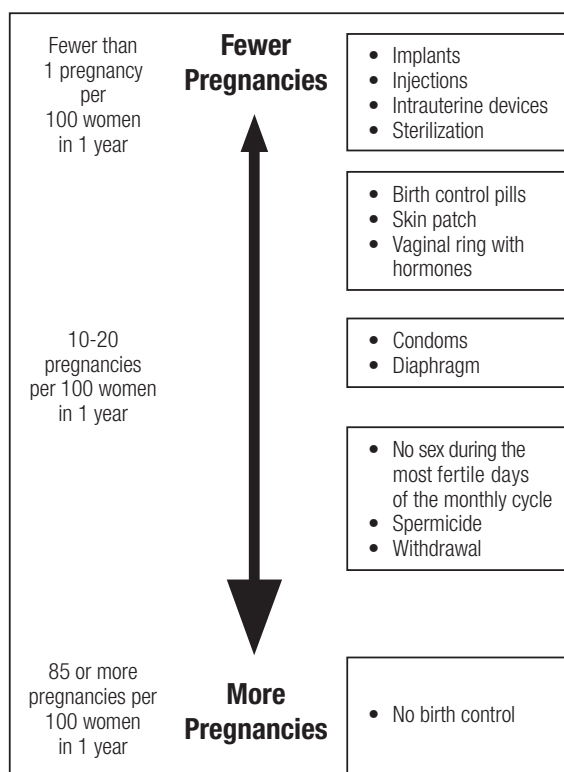
IMPLANON prevents pregnancy in several ways. The most important way is by stopping release of an egg from your ovary. IMPLANON also changes the mucus in your cervix and this change may keep sperm from reaching the egg. Also, IMPLANON changes the lining of your uterus.

**How well does IMPLANON® work?**

If IMPLANON is inserted correctly, your chance of getting pregnant is very low (less than 1 pregnancy per 100 women who use IMPLANON for 1 year). It is not known if IMPLANON is as effective in very overweight women because studies did not include many overweight women.

The following chart shows the chance of getting pregnant for women who use different methods of birth control. Each box on the chart contains a list of birth control methods that are similar in effectiveness. The most effective methods are at the top of the chart. The box on the bottom of the chart shows

the chance of getting pregnant for women who do not use birth control and are trying to get pregnant.



**Who should not use IMPLANON®?**

Do not use IMPLANON if you

- Are pregnant or think you may be pregnant
- Have, or have had serious blood clots, such as blood clots in your legs (deep venous thrombosis), lungs (pulmonary embolism), eyes (retinal thrombosis), heart (heart attack), or head (stroke)
- Have unexplained vaginal bleeding
- Have liver disease
- Have breast cancer, now or in the past
- Are allergic to anything in IMPLANON

Tell your healthcare provider if you have ever had any of the conditions just listed. Your healthcare provider can suggest another method of birth control.

In addition, talk to your healthcare provider about using IMPLANON if you have or had

- Diabetes
- High cholesterol or triglycerides
- Headaches
- Seizures or epilepsy
- Gallbladder or kidney disease
- Depression
- High blood pressure
- Allergic reaction to anesthetics or antiseptics. These medicines will be used when IMPLANON is inserted into your arm.

If you have any of these conditions, your healthcare provider can explain what to do.

**How do I use IMPLANON®?**

Your healthcare provider will insert (or remove) IMPLANON in a minor surgical procedure in his or her office. IMPLANON is inserted just under the skin on the inner side of your upper arm.

The timing of insertion is important. Depending on your history, your healthcare provider may ask you to

- Have a pregnancy test before insertion
- Schedule the insertion at a specific time of your cycle (for example, within the first days of your regular menstrual bleeding)
- Use a backup method of birth control, such as condoms, for 7 days after IMPLANON insertion

**Both you and your healthcare provider should check that IMPLANON is in your arm by feeling the IMPLANON implant.**

**If you and your healthcare provider cannot feel IMPLANON, use a non-hormonal birth control method such as condoms until your healthcare provider confirms that IMPLANON is in place.** You may need special tests to check that IMPLANON is in place or to help find IMPLANON when it is time to take it out.

You will be asked to review and sign a consent form prior to inserting IMPLANON. You will also get a USER CARD to keep at home with your health records. Your healthcare provider will fill out the insertion and removal dates. Keep track of the removal date and schedule an appointment for removal with your healthcare provider on or before the removal date.

The insertion site is covered with 2 bandages. Leave the top bandage on for 24 hours. Keep the smaller bandage dry, clean, and in place for 3 to 5 days. Be sure to have checkups as advised by your healthcare provider.

### **What are the most common side effects I can expect while using IMPLANON®?**

#### • Irregular and Unpredictable Bleeding

The most common side effect of IMPLANON is a change in your menstrual periods. In studies, about 1 out of 10 women stopped using IMPLANON because of bleeding problems. Expect your menstrual periods to be irregular and unpredictable throughout the time you are using IMPLANON. You may have more bleeding, less bleeding, or no bleeding. The time between periods may vary, and in between periods you may have spotting.

Talk with your healthcare provider if

- You think you may be pregnant
- Your vaginal bleeding is heavy and prolonged

Besides irregular bleeding, the most frequent side effects that caused women to stop using IMPLANON in studies were

- Mood swings
- Weight gain
- Headache
- Acne
- Depression

The most common side effects reported by women using IMPLANON in clinical trials were

- Irregular bleeding
- Headache
- Vaginitis (inflammation of the vagina)
- Weight gain
- Acne
- Breast pain
- Viral infections such as colds, sore throats, sinus infections, or flu-like symptoms
- Stomach pain
- Painful periods

- Mood swings, nervousness, or depression
- Back pain
- Nausea
- Dizziness
- Pain
- Pain at the site of insertion

Rare side effects that have been reported include: extra hair on your face and body, trouble using contact lenses, and spotty darkening of the skin, especially on the face. This is not a complete list of possible side effects. Talk to your healthcare provider if you have any side effects that concern you.

### **What are the possible risks of using IMPLANON®?**

#### • **Complications of Insertion and Removal**

Rarely, removal of IMPLANON is difficult or even impossible because IMPLANON is not where it should be. If IMPLANON cannot be removed, then the effects of IMPLANON will continue for a longer period of time.

Rarely, IMPLANON is not inserted at all due to a failed insertion, or the implant has fallen out of the needle, and then you may become pregnant. After insertion, and with direction from your healthcare provider, you should be able to feel IMPLANON under your skin. If you can't feel IMPLANON, tell your healthcare provider.

Some other problems related to insertion and removal are

- Pain, irritation, swelling, or bruising
- Scarring, including a thick scar called a keloid
- Infection
- IMPLANON breaks making it difficult to remove IMPLANON
- Thick scar tissue forming around IMPLANON making removal difficult
- Rarely, expulsion of the implant
- Rarely, need for surgery in the hospital for removal of IMPLANON
- Removals of deeply inserted implants can lead to scarring or complications such as damage to nerves or blood vessels

#### • **Ectopic Pregnancy**

If you become pregnant while using IMPLANON, you have a slightly higher chance that the pregnancy will be ectopic (occurring outside the womb) than do women who are not using birth control. Ectopic pregnancies can cause serious internal bleeding and even death.

#### • **Interaction With Other Medicines**

Certain medicines may make IMPLANON less effective and you may need to use back-up nonhormone birth control. Tell your healthcare provider about any medicines you are taking, or intend to take, including over-the-counter medicines and prescription medicines such as: barbiturates, griseofulvin, rifampin, phenylbutazone, phenytoin, carbamazepine, felbamate, oxcarbazepine, topiramate, and modafinil. Herbal remedies such as St. John's wort may also reduce the effectiveness of contraceptive drug products. This is not a complete list of drugs that may interact with IMPLANON.

When you are using IMPLANON, tell all of your healthcare providers that you have IMPLANON.

#### • **Ovarian Cysts**

Cysts on the ovaries usually go away without treatment. Sometimes surgery is needed.

#### • **Breast Cancer**

It is not known whether IMPLANON changes a woman's risk for breast cancer. If you have breast cancer now, or have had it in the past, do not use IMPLANON because some breast cancers are sensitive to hormones.

### • Blood Clots (Thrombosis)

It is not known whether IMPLANON changes a woman's risk for serious blood clots called thrombosis. Thrombosis is a side effect of birth control pills and pregnancy. Because IMPLANON contains 1 of the 2 hormones that are in birth control pills, thrombosis may be a side effect of IMPLANON. There have been postmarketing reports of thrombosis among IMPLANON users.

Some examples of thrombosis are

- Legs (deep vein thrombosis)
- Lung (pulmonary embolism)
- Brain (stroke)
- Heart (heart attack)
- Eyes (blindness)

The risk of thrombosis is increased in women who smoke. If you smoke, you should quit. Your healthcare provider may be able to help.

Tell your healthcare provider at least 4 weeks before if you are going to have surgery or will need to be on bed rest. You have an increased chance of getting thrombosis during surgery or bed rest.

### • Other Risks

A few women who use birth control that contains hormones may get

- High blood pressure
- Gallbladder problems
- Rare cancerous or noncancerous liver tumors

### When should I call my healthcare provider?

**Call your healthcare provider right away if you get any of the symptoms listed below. They may be signs of a serious problem.**

- Sharp chest pain, coughing blood, or sudden shortness of breath (possible clot in the lung)
- Persistent pain in the calf (back of lower leg) (possible clot in the leg)
- Crushing chest pain or heaviness in the chest (possible heart attack)
- Sudden severe headache or vomiting, dizziness or fainting, problems with vision or speech, weakness, or numbness in an arm or leg (possible stroke)
- Sudden partial or complete blindness (possible clot in the eye)
- Yellowing of the skin or whites of the eyes (jaundice), especially with fever, tiredness, loss of appetite, dark colored urine, or light colored bowel movements (possible liver problems)
- Severe pain, swelling, or tenderness in the abdomen (possibly indicating an ectopic pregnancy, a ruptured or twisted ovarian follicle, or gallbladder or liver problems)
- Breast lumps
- Difficulty in sleeping, weakness, lack of energy, tiredness, or sadness (possible severe depression)
- Heavy vaginal bleeding

### What if I become pregnant while using IMPLANON®?

You should see your healthcare provider right away. It is important to remove IMPLANON and make sure that the pregnancy is not ectopic (occurring outside the womb). Based on experience with birth control pills, IMPLANON is not likely to cause birth defects.

### Can I use IMPLANON® when I am breastfeeding?

Based on a small study, you may start IMPLANON if you are breastfeeding and if you delivered your baby more than 4 weeks ago. A small amount of the active substance of IMPLANON passes into the breast milk. The health of breastfed children whose mothers were using IMPLANON has been studied up to 3 years of age in a small number of children. No effects on the growth and development of the children were seen. If you are breastfeeding and want to use IMPLANON, talk with your healthcare provider.

### What if I want to become pregnant or want to stop using IMPLANON® for another reason before 3 years?

Your healthcare provider can remove IMPLANON at any time with a minor surgical procedure in the office. The information on your USER CARD may help your healthcare provider find IMPLANON.

After removal, keep the removal site clean, dry, and bandaged for 3 to 5 days to lessen the chance of infection.

If you want to become pregnant, your ability to get pregnant usually returns quickly. Some women have become pregnant within days after removal of IMPLANON. **If you do not want to become pregnant, you should start another birth control method right away.**

### **Additional Information**

This leaflet contains important information about IMPLANON®. If you would like more information, talk with your healthcare provider. You can ask your healthcare provider for information about IMPLANON that is written for healthcare providers. You may also call 1-877-IMPLANON (1-877-467-5266) or visit [www.IMPLANON-USA.com](http://www.IMPLANON-USA.com).

Manufactured by N.V. Organon, Oss, The Netherlands.  
Distributed by Schering Corporation, a subsidiary of  
Schering-Plough Corporation, Kenilworth, NJ 07033 USA.



© 2006, 2009, Schering Corporation. All rights reserved.  
Rev. 3/09

33294107T

# IMPLANON®

(etonogestrel implant)

68 mg For Subdermal Use Only

## PATIENT CONSENT FORM

I understand the Patient Labeling for IMPLANON®. I have discussed IMPLANON with my healthcare provider who answered all my questions. I understand that there are benefits as well as risks from using IMPLANON. I understand that there are other birth control methods and that each has its own benefits and risks.

I also understand that this Patient Consent Form is important. I understand that I need to sign this form to show that I am making an informed and careful decision to use IMPLANON, and that I have read and understand the following points.

- IMPLANON helps to keep me from getting pregnant.
- No contraceptive method is 100% effective, including IMPLANON.
- IMPLANON is made of a hormone mixed in a plastic rod.
- It is important to have IMPLANON inserted at the right time of my menstrual cycle.
- **After IMPLANON is inserted, I should check that it is in place by gently pressing my fingertips over the skin in my arm where IMPLANON was inserted. I should be able to feel the small rod.**
- IMPLANON must be removed at the end of 3 years. IMPLANON can be removed sooner if I want.
- If I have trouble finding a healthcare provider to remove IMPLANON, I can call (877) 467-5266 for help.
- IMPLANON is placed under the skin of my arm during a procedure done in my healthcare provider's office. There is a slight risk of getting a scar or an infection from this procedure.
- Removal is usually a small office procedure. However, removal may be difficult. Rarely, IMPLANON cannot be found when it is time to remove it. Special procedures, including surgery in the hospital, may be needed. Difficult removals may cause pain and scarring and may result in damage to nerves and blood vessels. If IMPLANON cannot be found, its effects may continue.
- **Most women have changes in their menstrual bleeding while using IMPLANON. I also will likely have changes in my menstrual bleeding while using IMPLANON. My bleeding may be irregular, lighter or heavier, or my bleeding may completely stop. If I think I am pregnant, I should see my healthcare provider as soon as possible.**

- I understand the warning signs for problems with IMPLANON. I should seek medical attention if any warning signs appear.
- I should tell all my healthcare providers that I am using IMPLANON.
- I need to have a medical checkup regularly and at any time I am having problems.
- IMPLANON does not protect me from HIV infection (AIDS) or any other sexually transmitted disease.

After learning about IMPLANON, I choose to use IMPLANON.

\_\_\_\_\_  
(Name of Healthcare Provider)

\_\_\_\_\_  
(Patient Signature)

\_\_\_\_\_  
(Date)

WITNESSED BY:

The patient above has signed this consent in my presence after I counseled her and answered her questions.

\_\_\_\_\_  
(Healthcare Provider Signature)

\_\_\_\_\_  
(Date)

I have provided an accurate translation of this information to the patient whose signature appears above. She has stated that she understands the information and has had an opportunity to have her questions answered.

\_\_\_\_\_  
(Signature of Translator)

\_\_\_\_\_  
(Date)

Manufactured by N.V. Organon, Oss, The Netherlands.  
Distributed by Schering Corporation, a subsidiary of  
Schering-Plough Corporation, Kenilworth, NJ 07033 USA.

